

S.C. ETAJ 1-2 = 435.67mp

5/9 - Ap. 3Cam.

Su= 83.75mp / Sut (cu terase)=92.62mp
Sc= 104.21mp / Sct (cu terase)=114.61mp

6/10 - Ap. 3Cam.

Su= 79.71mp / Sut (cu terase)=93.10mp
Sc= 98.16mp / Sct (cu terase)=113.76mp

7/11 - Ap. 3Cam.

Su= 63.18mp / Sut (cu terase)= 71.01mp
Sc= 79.90mp / Sct (cu terase)=89.29mp

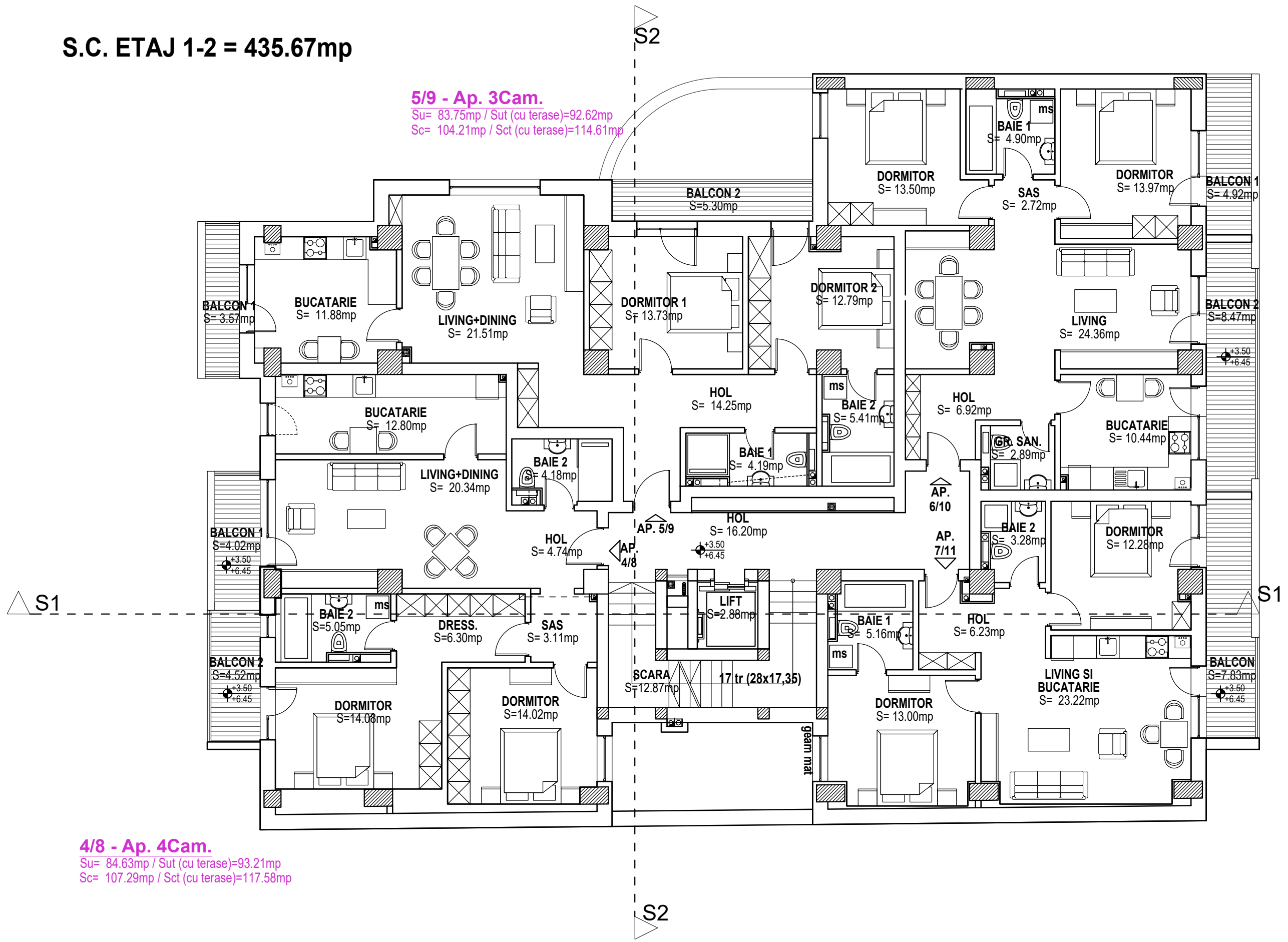

4/8 - Ap. 4Cam.

Su= 84.63mp / Sut (cu terase)=93.21mp
Sc= 107.29mp / Sct (cu terase)=117.58mp