

S.C. ETAJ 3 = 329.23mp

12 - Ap. 2Cam.
 Su= 56.26mp / Sut (cu terase)=61.56mp
 Sc= 69.39mp / Sct (cu terase)=75.22mp

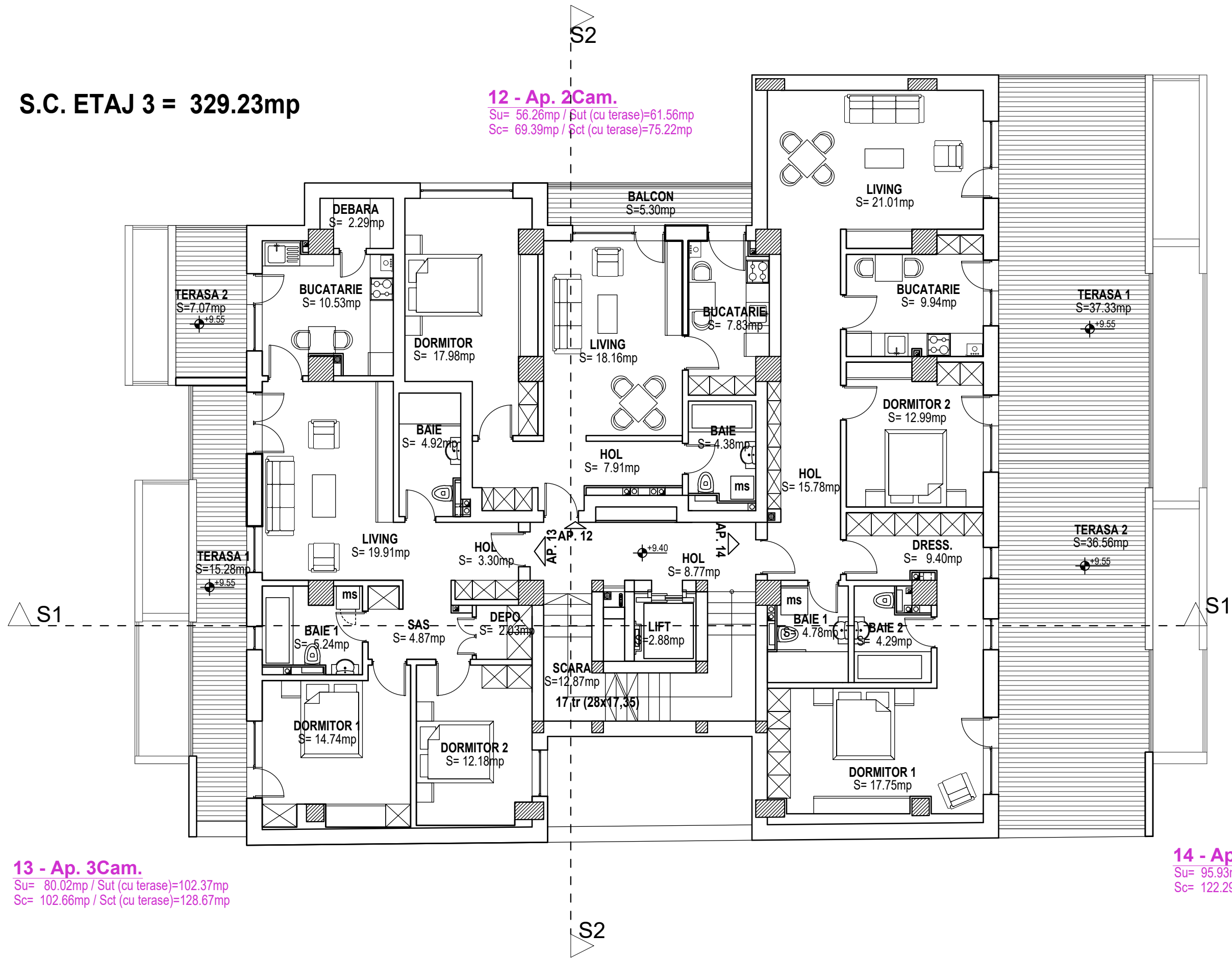

13 - Ap. 3Cam.
 Su= 80.02mp / Sut (cu terase)=102.37mp
 Sc= 102.66mp / Sct (cu terase)=128.67mp

14 - Ap. 3Cam.
 Su= 95.93mp / Sut (cu terase)=169.82mp
 Sc= 122.29mp / Sct (cu terase)=201.29mp